

Vibration & Temperature Sensor With Serial Interface Modbus RTU QM30VT2

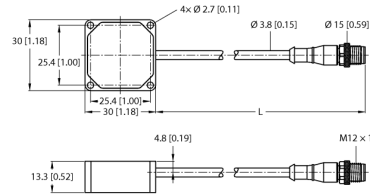

- For detecting temperature and vibration values
- Robust Aluminium Housing
- Protection class IP67
- M12 x 1 cable with male end, PVC, 2.09 m, 5-pin
- Operating voltage: 10...24 VDC or 3.6...5.5 VDC
- Temperature measuring range: -40...105 °C
- Resolution: 1 °C
- Accuracy: ± 3 °C
- Vibration measuring range: 0...46 mm/s RMS
- Frequency range: 10...4000 Hz
- Accuracy: ± 10 % at 25 °C
- Shock resistant up to 400g
- RS485 interface, supports Modbus RTU
- BWA-BK-014 mounting plate kit included in delivery

Wiring Diagram

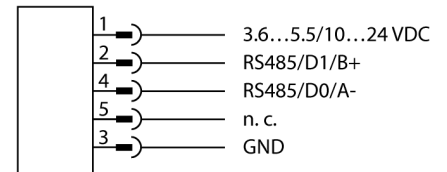

Functional principle

This sturdy sensor in a metal housing was developed to monitor vibrations and the temperature of moving machine parts. The data can be transferred to a controller via the RS485 interface, thus enabling an imminent failure of the machine to be identified at an early stage and corrective action to be taken. The rugged housing is IP67-rated and allows the detection of vibrations on two axes. The sensor can be mounted or stuck on the machine with the relevant accessories.

Type designation	QM30VT2
Ident no.	3806276
Wireless data	
Function	Vibration sensor
Device type	Sensor
Design	Rectangular
Housing material	Aluminium, AL, Black-finished
Ambient temperature	-40...+105 °C
Protection class	IP67
Dimensions	30 x 13.25 x 30 mm
Operating voltage	10...≤ 24 VDC
Tests/approvals	

Vibration & Temperature Sensor

With Serial Interface

Modbus RTU

QM30VT2

Accessories

Type code	Ident no.	Description	Dimension drawing
BWA-BK-014	3807958		
BWA-BK-013	3807394		

Function accessories

Type code	Ident no.	Description	Dimension drawing
BWA-HW-006	3081325	Converter cable, RS485 to USB 2.0 converter, female, M12 × 1, 5-pin, male, USB type A, length 1 m; supplies the connected device with 10 V. An external power supply via a Y-splitter is recommended for the connected device	